

CUSTOM THREADED SPACERS

Threaded Spacers

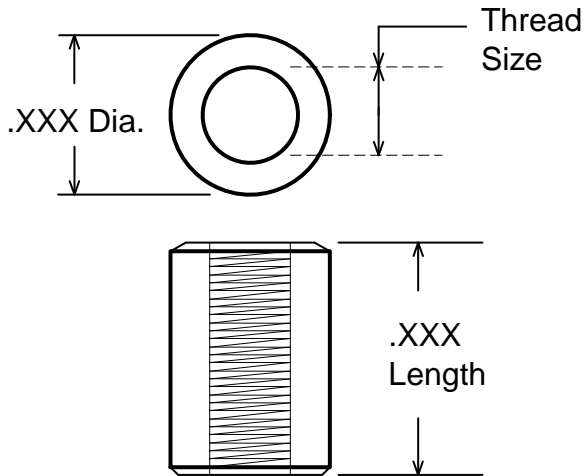

Threaded Spacers are Available in Diameters of :

1/4" - .250" (6,35) 5/16" - .312" (7,92)

3/8" - .375" (9,53) 1/2" - .500" (12,70)

3/4" - .750" (19,05)

WITH THREAD SIZES OF: 6-32 8-32 10-24 M4 x .7

THREADED SPACERS OVER 1.500" (38,10) IN LENGTH ARE TAPPED TO A DEPTH OF 1.000" (25,40) FROM EACH END.

**MATERIAL : SPACERS - DELRIN
INSERTS - BRASS**

Spacers with Threaded Brass Inserts

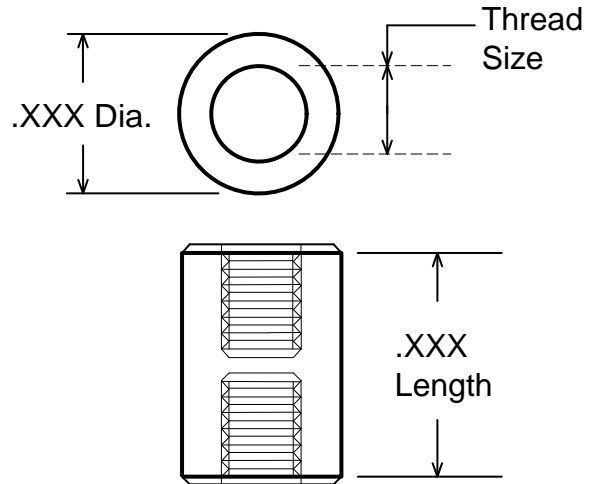

Spacers with Threaded Brass Inserts are Available in the following Diameters

3/8" - .375" (9,53) 1/2" - .500" (12,70)

3/4" - .750" (19,05)

WITH THREAD SIZES OF: 6-32 8-32 10-24

MINIMUM LENGTH WITH: 6-32 INSERT - .500" (12,70)

8-32 INSERT - .670" (17,02)

10-24 INSERT - .750" (19,05)

PLEASE NOTE THAT THE THREADED INSERTS ARE NOT ALIGNED WITH EACH OTHER, AND ARE DESIGNED TO HAVE A SCREW ENTER FROM EACH END. A SCREW WILL NOT PASS ALL THE WAY THROUGH THE SPACER.

FOR SPACERS WITH INSERTS, ADD (I) TO THE END OF THE PART NUMBER.

To Order Develop a Part Number Using the over all Length, with the Diameter and Thread size, for spacers with inserts add the letter (I) on the end of the part number

EXAMPLE:

TX - 750 - 500 - 6/32 - DS (I) --- Threaded Insert

OVER ALL LENGTH ———
DIAMETER ——— THREAD SIZE

TEST-X FIXTURE PRODUCTS 7117 Arlington Ave. Ste. G

www.test-x.com

Riverside, CA 92503

pH. 951-688-3067 Fax 951-688-1543