

FLAT HEAD SCREWS

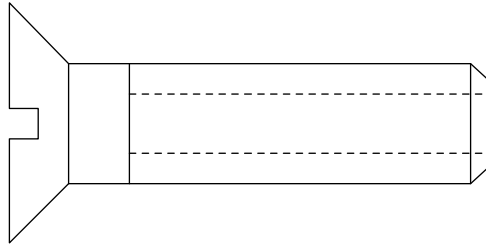

<u>AVAILABLE THREADED SIZES</u>
6-32
8-32
10-24

<u>AVAILABLE LENGTHS</u>	
1/4"	(6,35)
3/8"	(9,53)
1/2"	(12,70)
5/8"	(15,88)
3/4"	(19,05)
1"	(25,40)
1 1/4"	(31,75)
1 1/2"	(38,10)
1 5/8"	(41,28)
1 3/4"	(44,45)
2"	(57,15)

MATERIAL: NYLON OR STAINLESS STEEL

DEVELOP A PART NUMBER USING LENGTH AND THREAD SIZE AND MATERIAL

EXAMPLE : LENGTH THREAD SIZE HEAD TYPE MATERIAL
TX - 1/4 - 6-32 - FH - N or S

TEST-X FIXTURE PRODUCTS 7117 Arlington Ave. Ste. G
www.test-x.com Riverside, CA 92503
pH. 951-688-3067 Fax 951-688-1543