

CONE HEAD BUTTON TOOLING PINS

STANDARD HEAD DIAMETERS	
.095"	(2,41)
.109"	(2,77)
.120"	(3,04)
.124"	(3,15)
.135"	(3,43)
.145"	(3,68)
.155"	(3,94)
.185"	(4,70)
.248"	(6,29)

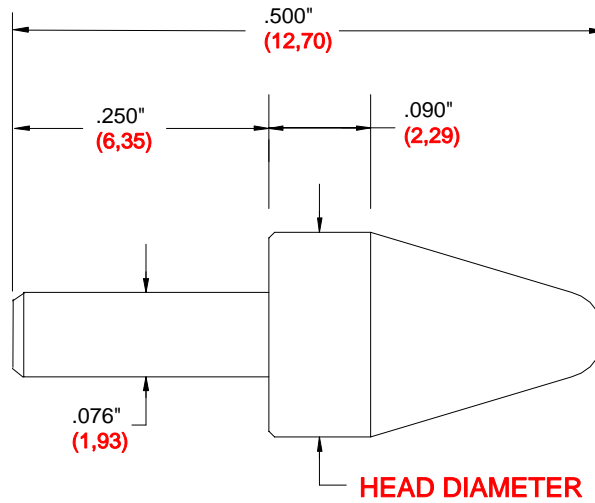

CUSTOM SIZES AVAILABLE CALL (951) 688-3067

TO ORDER, DEVELOP A PART NUMBER USING THE HEAD DIAMETER FROM THE CHART.

EXAMPLE: **TX - 500 - 095 - CHBTP**

MATERIAL : STAINLESS STEEL

└── HEAD DIAMETER

TEST-X FIXTURE PRODUCTS

www.test-x.com

7117 Arlington Ave. Ste. G

Riverside, CA 92503

pH. 951-688-3067 Fax 951-688-1543